

MITERED CABINET 6

MOULDING # **MC 6**

CUSTOMER: _____

COMMENTS: _____

[HOME](#)

[PROFILE CATALOG](#)

[CUSTOM KNIVES](#)

[ORDER](#)

[TOOLING](#)

MC 6 is the double beaded cabinet door you've seen just about everywhere. Gorgeously accented by a raised panel, it is equally at home in a farm house with a T&G inset panel.



We will never put parting legs on a moulding knife unless the customer specifically request it. On this pattern the knife would "flare off" the cut after creating the outer bead.

INSIDE OF MACHINE (FENCE)

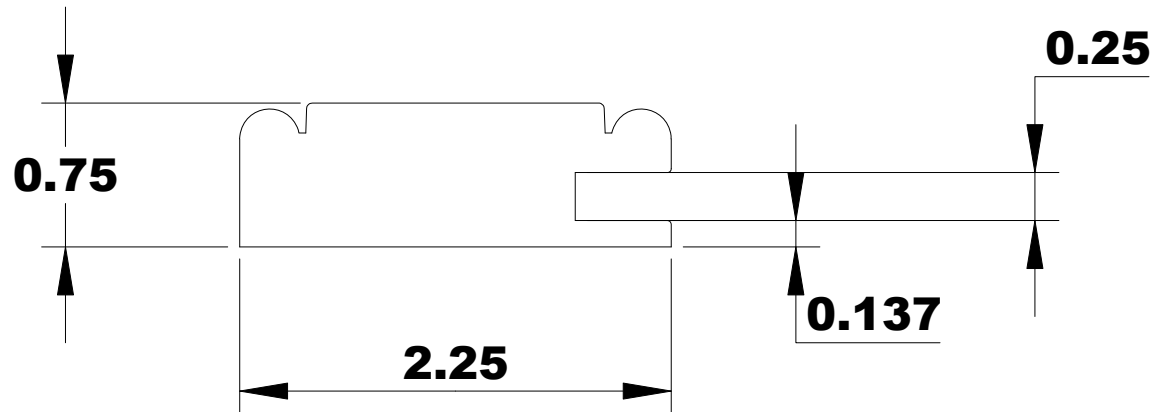

OUTFEED VIEW COMING