

# CHAIR RAIL 26

MOULDING # **CH 26**

CUSTOMER: \_\_\_\_\_

COMMENTS: \_\_\_\_\_

[HOME](#)

[PROFILE CATALOG](#)

[CUSTOM KNIVES](#)

[ORDER](#)

[TOOLING](#)

2 1/2 X 11/16 CHAIR RAIL 26  
ADD ELEGANCE TO ANY SITTING ROOM WITH  
HIGH QUALITY SHAPER KNIVES AND MOULDING  
CUTTERS. HIGH SPEED STEEL KNIFE SETS MADE  
QUICKLY TO DEMANDING SPECIFICATIONS.

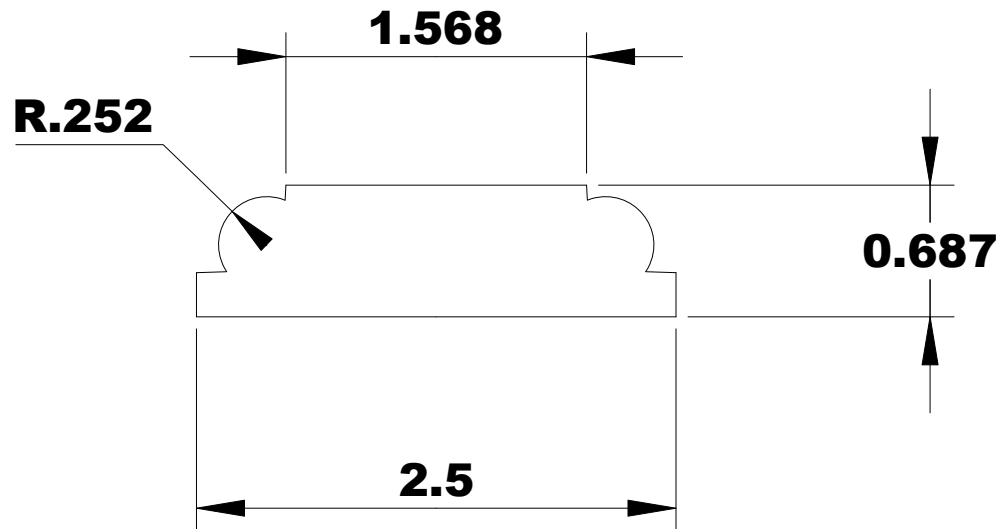

INSIDE OF MACHINE ( FENCE )

OUTFEED VIEW COMING